

| Internal Hall IV Area in Sq. mt. | | | |
|----------------------------------|-----|----|-------|
| A=HALL | 180 | 60 | 10800 |
| B=DINNING HALL | 12 | 90 | 1080 |
| C=GENITS TOILTE (5NOS) | 9 | 5 | 225 |
| D=LADIES TOILET (6NOS) | 9 | 5 | 270 |
| Total area | | | 12375 |

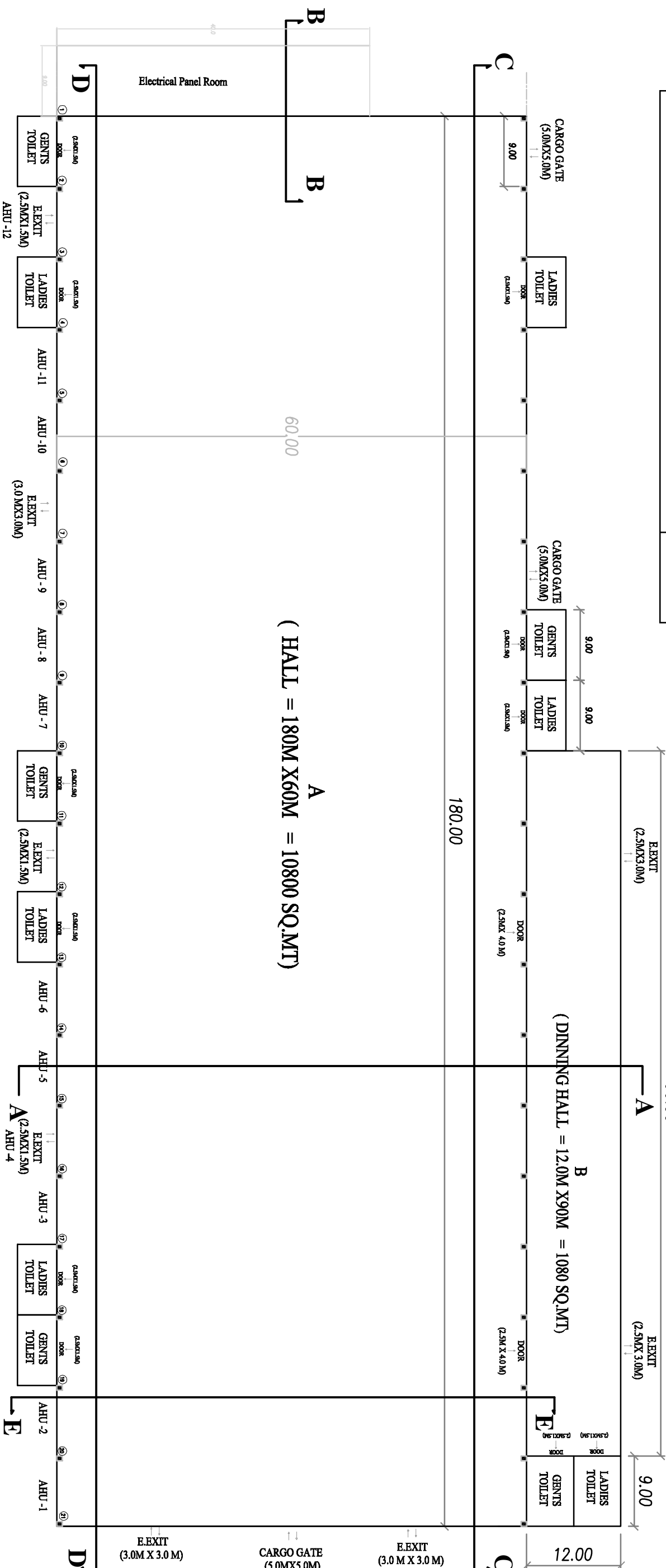
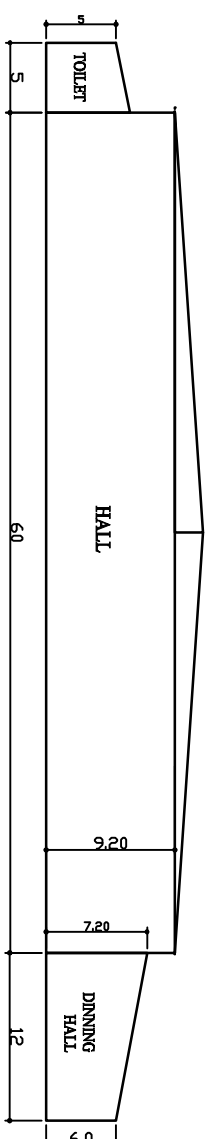

(HALL = 180M X60M = 10800 SQ.MT)

(DINNING HALL = 12.0M X90M = 1080 SQ.MT)

HALL NO. IV

(FORMERLY - HALL VIIA)

